

鎢鋼微小徑內車刀

Carbide Micro Boring



車銑複合 走心車床
 Multi-tasking Turn-Mill spindle
 Lathes, Swiss Type

60度內螺紋車刀

Internal Partial Profile 60°

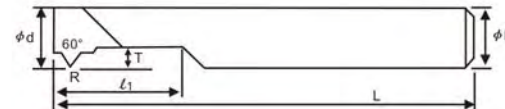

產品編號 CODE	外徑 d	牙距 Pitch	R	T	有效長 ℓ ₁	全長 L	柄徑 D	最小孔徑 Min Bore dia
ALIH3-A60L08	2.4	0.5	0.05	0.5	8	50	3	2.5
ALIH3-A60L10	3	0.5-0.7	0.05	0.75	10	50	3	3.2
ALIH4-A60L10	4	0.5-0.8	0.05	0.85	10	50	4	4.2
ALIH6-A60L10	5	0.5-1.25	0.05	1.3	10	50	6	5.2
ALIH6-A60L12	6	0.5-1.5	0.05	1.55	12	50	6	6.2
ALIH3-A60L16	3	0.5-0.7	0.05	0.75	16	50	3	3.2
ALIH4-A60L16	4	0.5-0.8	0.05	0.85	16	50	4	4.2
ALIH6-A60L16	5	0.5-1.25	0.05	1.3	16	50	6	5.2
ALIH6-A60L18	6	0.5-1.5	0.05	1.55	18	50	6	6.2
ALIH8-A60L20	7.4	1.0-1.5	0.08	1.9	20	60	8	7.6
ALIH10-A60L20	9.6	1.0-2.0	0.08	2.4	20	75	10	9.8
ALIH12-A60L20	11.4	1.0-2.0	0.08	3.2	20	75	12	11.6

※特殊規格圖面可訂製 Make to order for special specification. as per drawing

不等分割鎢鋼銑刀
Irregular Helix Flutes

微型孔加工工具
Microscope

NACO 銑刀系列
NACO Mill

NACO 切削基準
Cutting Speed Specifications



微小溝槽 Micro Grooving

不等分割錐鋼銑刀
Irregular Helix Flutes

微型孔加工工具
Microscope

NACO 銑刀系列
NACO Mill

NACO 切削基準
Cutting Speed Specifications

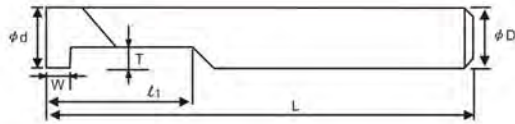

產品編號 CODE	外徑 d	W	T	有效長 L ₁	全長 L	柄徑 D	最小孔徑 Min Bore dia
BLIH3-W030L12	3	0.3	0.6	12	50	3	3.1
BLIH3-W040L12	3	0.4	0.8	12	50	3	3.1
BLIH4-W050L12	4	0.5	1.25	12	50	4	4.1
BLIH4-W060L12	4	0.6	1.25	12	50	4	4.1
BLIH4-W070L12	4	0.7	1.25	12	50	4	4.1
BLIH4-W080L12	4	0.8	1.25	12	50	4	4.1
BLIH6-W090L16	6	0.9	2	16	50	6	6.1
BLIH6-W100L16	6	1	2	16	50	6	6.1
BLIH6-W120L16	6	1.2	2	16	50	6	6.1
BLIH6-W140L16	6	1.4	2	16	50	6	6.1
BLIH6-W160L16	6	1.6	2	16	50	6	6.1
BLIH6-W180L16	6	1.8	2	16	50	6	6.1
BLIH8-W200L20	8	2	3.5	20	60	8	8.1
BLIH8-W250L20	8	2.5	3.5	20	60	8	8.1
BLIH10-W300L20	10	3	4.5	20	75	10	10.1
BLIH10-W350L20	10	3.5	4.5	20	75	10	10.1
BLIH10-W400L20	10	4	4.5	20	75	10	10.1

※特殊規格圖面可訂製 Make to order for special specification. as per drawing



微圓溝槽 Micro Grooving Round



不等分割錐鋼銑刀
Irregular Helix Flutes

微型孔加工工具
Microscope

NACO 銑刀系列
NACO Mill

NACO 切削基準
Cutting Speed Specifications

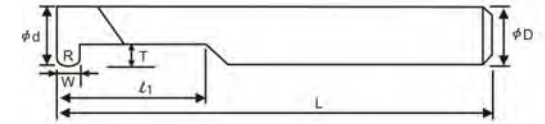

產品編號 CODE	外徑 d	R	W	T	有效長 L ₁	全長 L	柄徑 D	最小孔徑 Min Bore dia
CLIH3-R03L12	3	0.3	0.6	0.8	12	50	3	3.1
CLIH3-R04L12	3	0.4	0.8	0.8	12	50	3	3.1
CLIH4-R03L12	4	0.3	0.6	1.4	12	50	4	4.1
CLIH4-R04L12	4	0.4	0.8	1.4	12	50	4	4.1
CLIH4-R05L12	4	0.5	1	1.4	12	50	4	4.1
CLIH4-R06L12	4	0.6	1.2	1.4	12	50	4	4.1
CLIH6-R05L16	6	0.5	1	2	16	50	6	6.1
CLIH6-R06L16	6	0.6	1.2	2	16	50	6	6.1
CLIH6-R07L16	6	0.7	1.4	2	16	50	6	6.1
CLIH6-R08L16	6	0.8	1.6	2	16	50	6	6.1
CLIH6-R09L16	6	0.9	1.8	2	16	50	6	6.1
CLIH6-R10L16	6	1	2	2	16	50	6	6.1
CLIH8-R10L21	8	1	2	2.5	21	60	8	8.1
CLIH8-R15L21	8	1.5	3	2.5	21	60	8	8.1
CLIH10-R10L26	10	1	2	3.5	26	75	10	10.1
CLIH10-R15L26	10	1.5	3	3.5	26	75	10	10.1
CLIH10-R20L26	10	2	4	3.5	26	75	10	10.1

※特殊規格圖面可訂製 Make to order for special specification. as per drawing





端面切溝刀 Micro Face Grooving

不等分割錐鋼銑刀
Irregular Helix Flutes

微型孔加工工具
Microscope

NACO 銑刀系列
NACO Mill

NACO 切削基準
Cutting Speed Specifications

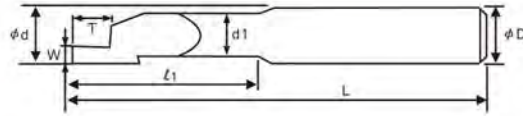

產品編號 CODE	外徑 d	W	T	頸徑 d1	有效長 ℓ ₁	全長 L	柄徑 D
DLIH4-W070L12	4	0.7	1	3.2	12	50	4
DLIH4-W080L12	4	0.8	1.1	3.2	12	50	4
DLIH4-W090L12	4	0.9	1.2	3.2	12	50	4
DLIH4-W100L12	4	1	1.3	3.2	12	50	4
DLIH6-W070L16	6	0.7	1	5	16	50	6
DLIH6-W080L16	6	0.8	1.1	5	16	50	6
DLIH6-W090L16	6	0.9	1.2	5	16	50	6
DLIH6-W100L16	6	1	1.3	5	16	50	6
DLIH6-W110L16	6	1.1	1.4	5	16	50	6
DLIH6-W120L16	6	1.2	1.5	5	16	50	6
DLIH8-W100L20	8	1	1.3	6	20	60	8
DLIH8-W200L20	8	2	2.3	6	20	60	8
DLIH10-W200L25	10	2	2.3	8	25	75	10
DLIH10-W300L25	10	3	3.5	8	25	75	10

※特殊規格圖面可訂製 Make to order for special specification, as per drawing



微小內徑車刀 Micro Boring



不等分割錐鋼銑刀
Irregular Helix Flutes

微型孔加工工具
Microscope

NACO 銑刀系列
NACO Mill

NACO 切削基準
Cutting Speed Specifications

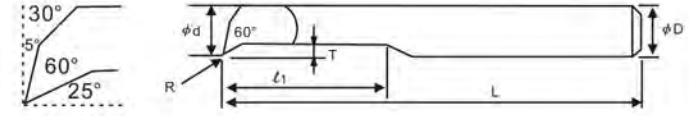

產品編號 CODE	外徑 d	R	T	有效長 ℓ ₁	全長 L	柄徑 D	最小孔徑 Min Bore dia
ELIH3-01R005L03	1	0.05	0.2	3	50	3	1.2
ELIH3-01R010L05	1	0.1	0.2	5	50	3	1.2
ELIH3-02R010L06	2	0.1	0.4	6	50	3	2.2
ELIH3-02R010L09	2	0.1	0.4	9	50	3	2.2
ELIH3-03R010L10	3	0.1	0.7	10	50	3	3.2
ELIH3-03R010L15	3	0.1	0.7	15	50	3	3.2
ELIH4-04R010L11	4	0.1	0.7	11	50	4	4.2
ELIH4-04R010L16	4	0.1	0.7	16	50	4	4.2
ELIH4-04R010L21	4	0.1	0.7	21	50	4	4.2
ELIH6-06R015L11	6	0.15	0.8	11	50	6	6.2
ELIH6-06R015L16	6	0.15	0.8	16	50	6	6.2
ELIH6-06R015L21	6	0.15	0.8	21	50	6	6.2
ELIH8-08R020L15	8	0.2	0.9	15	60	8	8.2
ELIH8-08R020L20	8	0.2	0.9	20	60	8	8.2
ELIH8-08R020L25	8	0.2	0.9	25	60	8	8.2
ELIH10-10R020L20	10	0.2	1	20	75	10	10.2
ELIH10-10R020L25	10	0.2	1	25	75	10	10.2
ELIH10-10R020L30	10	0.2	1	30	75	10	10.2

※特殊規格圖面可訂製 Make to order for special specification, as per drawing





仿削刀 Micro Copy

不等分割錐鋼銑刀
Irregular Helix Flutes

微型孔加工工具
Microscope

NACO 銑刀系列
NACO Mill

NACO 切削基準
Cutting Speed Specifications

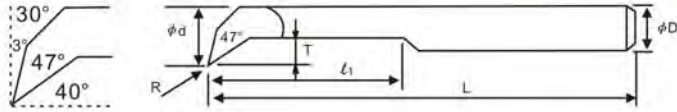

產品編號 CODE	外徑 d	R	T	有效長 L_1	全長 L	柄徑 D	最小孔徑 Min Bore dia
FLIH4-4R010L11	4	0.1	1	11	50	4	4.2
FLIH4-4R010L16	4	0.1	1	16	50	4	4.2
FLIH4-4R010L21	4	0.1	1	21	50	4	4.2
FLIH6-6R015L11	6	0.15	1.3	11	50	6	7
FLIH6-6R015L16	6	0.15	1.3	16	50	6	7
FLIH6-6R015L21	6	0.15	1.3	21	50	6	7

※特殊規格圖面可訂製 Make to order for special specification. as per drawing



後邊刀 Micro Back Edge

不等分割錐鋼銑刀
Irregular Helix Flutes

微型孔加工工具
Microscope

NACO 銑刀系列
NACO Mill

NACO 切削基準
Cutting Speed Specifications

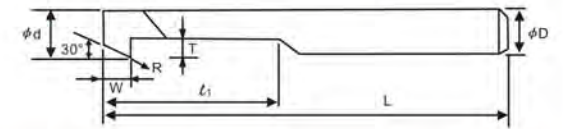

產品編號 CODE	外徑 d	R	W	T	有效長 L_1	全長 L	柄徑 D	最小孔徑 Min Bore dia
GLIH3-3R010L11	3	0.1	1.5	0.8	11	50	3	3.1
GLIH3-3R010L16	3	0.1	1.5	0.8	16	50	3	3.1
GLIH4-4R010L11	4	0.1	2	1.3	11	50	4	4.1
GLIH4-4R010L16	4	0.1	2	1.3	16	50	4	4.1
GLIH4-4R010L21	4	0.1	2	1.3	21	50	4	4.1
GLIH6-6R020L11	6	0.2	2	1.9	11	50	6	6.1
GLIH6-6R020L16	6	0.2	2	1.9	16	50	6	6.1
GLIH6-6R020L21	6	0.2	2	1.9	21	50	6	6.1

※特殊規格圖面可訂製 Make to order for special specification. as per drawing





內倒角45度車刀

Micro Copy

不等分割錐鋼銑刀
Irregular Helix Flutes

微型孔加工工具
Microscope

NACO 銑刀系列
NACO Mill

NACO 切削基準
Cutting Speed Specifications

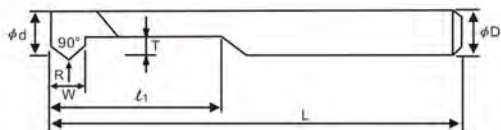

產品編號 CODE	外徑 d	R	W	T	有效長 L_1	全長 L	柄徑 D	最小孔徑 Min Bore dia
HLIH4-R010W2L11	4	0.1	2	1.2	11	50	4	4.1
HLIH4-R010W2L16	4	0.1	2	1.2	16	50	4	4.1
HLIH4-R010W2L21	4	0.1	2	1.2	21	50	4	4.1
HLIH6-R020W24L11	6	0.2	2.4	1.5	11	50	6	6.1
HLIH6-R020W24L16	6	0.2	2.4	1.5	16	50	6	6.1
HLIH6-R020W24L21	6	0.2	2.4	1.5	21	50	6	6.1

* 特殊規格圖面可訂製 Make to order for special specification. as per drawing